

# FIFTH FLOOR

## block A

**APARTMENT № 40A**  
 pertinents:  
 - area – 69.72m<sup>2</sup>  
 - shared parts – 14.87 m<sup>2</sup>  
 - total area – 84.59 m<sup>2</sup>  
 - terrace – 13.10 m<sup>2</sup>  
 description:  
 - 2 bedrooms  
 - view – POOL & SEA  
 boundaries:  
 - north & east – yard  
 - west – corridor  
 - south – ap. № 19A

**APARTMENT № 43A**  
 pertinents:  
 - area – 37.10 m<sup>2</sup>  
 - shared parts – 7.91 m<sup>2</sup>  
 - total area – 45.01 m<sup>2</sup>  
 - terrace – 4.69 m<sup>2</sup>  
 description:  
 - studio  
 - view – POOL & SEA  
 boundaries:  
 - east – yard  
 - west – corridor  
 - north – ap. № 20A  
 - south – ap. № 22A

**APARTMENT № 46A**  
 pertinents:  
 - area – 76.85 m<sup>2</sup>  
 - shared parts – 16.39 m<sup>2</sup>  
 - total area – 93.24 m<sup>2</sup>  
 - terrace – 11.77 m<sup>2</sup>  
 description:  
 - 2 bedrooms  
 - view – WEST  
 boundaries:  
 - east – corridor  
 - west – yard  
 - north – ap. № 25A  
 - south – store, staircase

**APARTMENT № 49A**  
 pertinents:  
 - area – 51.50 m<sup>2</sup>  
 - shared parts – 10.99 m<sup>2</sup>  
 - total area – 62.49 m<sup>2</sup>  
 - terrace – 9.07 m<sup>2</sup>  
 description:  
 - studio  
 - view – WEST  
 boundaries:  
 - east – ap. № 28A  
 - west – corridor  
 - north – ap. № 23A  
 - south – ap. № 26A, corridor

**APARTMENT № 31B**  
 pertinents:  
 - area – 73.15 m<sup>2</sup>  
 - shared parts – 15.60 m<sup>2</sup>  
 - total area – 88.75 m<sup>2</sup>  
 - terrace – 9.56 m<sup>2</sup>  
 description:  
 - 1 bedroom  
 - view – POOL & SEA  
 boundaries:  
 - east – yard  
 - west – corridor  
 - north – ap. № 23A  
 - south – ap. № 12B

**APARTMENT № 36B**  
 pertinents:  
 - area – 73.30 m<sup>2</sup>  
 - shared parts – 15.64 m<sup>2</sup>  
 - total area – 88.94 m<sup>2</sup>  
 - terrace – 9.56 m<sup>2</sup>  
 description:  
 - 1 bedroom  
 - view – POOL & SEA  
 boundaries:  
 - east – yard  
 - west – corridor  
 - north – ap. № 15B  
 - south – ap. № 12C

**APARTMENT № 34C**  
 pertinents:  
 - area – 53.90 m<sup>2</sup>  
 - shared parts – 11.50 m<sup>2</sup>  
 - total area – 65.40 m<sup>2</sup>  
 - terrace – 6.91 m<sup>2</sup>  
 description:  
 - 1 bedroom  
 - view – POOL  
 boundaries:  
 - east – yard  
 - west – corridor  
 - north – ap. № 16B  
 - south – ap. № 13C

**APARTMENT № 37C**  
 pertinents:  
 - area – 53.66 m<sup>2</sup>  
 - shared parts – 11.45 m<sup>2</sup>  
 - total area – 65.11 m<sup>2</sup>  
 - terrace – 4.75 m<sup>2</sup>  
 description:  
 - studio  
 - view – POOL  
 boundaries:  
 - east & south – corridor  
 - north – yard  
 - west – ap. № 14C

**APARTMENT № 40C**  
 pertinents:  
 - area – 38.78 m<sup>2</sup>  
 - shared parts – 8.27 m<sup>2</sup>  
 - total area – 47.05 m<sup>2</sup>  
 - terrace – 5.93 m<sup>2</sup>  
 description:  
 - studio  
 - view – WEST  
 boundaries:  
 - east & north – corridor  
 - west – ap. № 19C  
 - south – yard

**APARTMENT № 43C**  
 pertinents:  
 - area – 78.20 m<sup>2</sup>  
 - shared parts – 16.68 m<sup>2</sup>  
 - total area – 94.88 m<sup>2</sup>  
 - terrace – 12.16 m<sup>2</sup>  
 description:  
 - studio  
 - view – WEST  
 boundaries:  
 - east – corridor  
 - west – yard  
 - north – ap. № 22C  
 - south – ap. № 20C

**APARTMENT № 41A**  
 pertinents:  
 - area – 70.34 m<sup>2</sup>  
 - shared parts – 15.01 m<sup>2</sup>  
 - total area – 85.35 m<sup>2</sup>  
 - terrace – 13.10 m<sup>2</sup>  
 description:  
 - 2 bedrooms  
 - view – POOL & SEA  
 boundaries:  
 - east & south – yard  
 - north – ap. № 18A  
 - west – corridor

**APARTMENT № 44A**  
 pertinents:  
 - area – 55.37 m<sup>2</sup>  
 - shared parts – 11.81 m<sup>2</sup>  
 - total area – 67.18 m<sup>2</sup>  
 - terrace – 6.81 m<sup>2</sup>  
 description:  
 - 1 bedroom  
 - view – POOL & SEA  
 boundaries:  
 - east – yard  
 - west – corridor  
 - north – ap. № 21A  
 - south – ap. № 23A

**APARTMENT № 47A**  
 pertinents:  
 - area – 78.43  
 - shared parts – 16.73 m<sup>2</sup>  
 - total area – 95.16 m<sup>2</sup>  
 - terrace – 12.16 m<sup>2</sup>  
 description:  
 - 2 bedrooms  
 - view – WEST  
 boundaries:  
 - east – corridor  
 - west – yard  
 - north – ap. № 26A  
 - south – ap. № 24A

**APARTMENT № 50A**  
 pertinents:  
 - area – 38.82 m<sup>2</sup>  
 - shared parts – 8.28 m<sup>2</sup>  
 - total area – 47.10 m<sup>2</sup>  
 - terrace – 5.93 m<sup>2</sup>  
 description:  
 - studio  
 - view – WEST  
 boundaries:  
 - east & south – corridor  
 - west – yard  
 - north – ap. № 18B  
 - south – ap. № 13B

**APARTMENT № 32B**  
 pertinents:  
 - area – 57.48 m<sup>2</sup>  
 - shared parts – 12.26 m<sup>2</sup>  
 - total area – 69.74 m<sup>2</sup>  
 - terrace – 8.50 m<sup>2</sup>  
 description:  
 - 1 bedroom  
 - view – POOL & SEA  
 boundaries:  
 - east – yard  
 - west – corridor  
 - north – ap. № 11B  
 - south – ap. № 13B

**APARTMENT № 37B**  
 pertinents:  
 - area – 60.69 m<sup>2</sup>  
 - shared parts – 12.95 m<sup>2</sup>  
 - total area – 73.64 m<sup>2</sup>  
 - terrace – 11.23 m<sup>2</sup>  
 description:  
 - 1 bedroom  
 - view – WEST  
 boundaries:  
 - east – corridor  
 - west – yard  
 - north – ap. № 18B  
 - south – staircase

**APARTMENT № 35C**  
 pertinents:  
 - area – 51.76 m<sup>2</sup>  
 - shared parts – 11.04 m<sup>2</sup>  
 - total area – 62.80 m<sup>2</sup>  
 - terrace – 6.81 m<sup>2</sup>  
 description:  
 - 1 bedroom  
 - view – POOL  
 boundaries:  
 - east – yard  
 - west – corridor  
 - north – ap. № 12C  
 - south – ap. № 14C

**APARTMENT № 38C**  
 pertinents:  
 - area – 70.20m<sup>2</sup>  
 - shared parts – 14.98 m<sup>2</sup>  
 - total area – 85.18 m<sup>2</sup>  
 - terrace – 10.69 m<sup>2</sup>  
 description:  
 - 2 bedrooms  
 - view – POOL  
 boundaries:  
 - north & east – yard  
 - west – corridor  
 - south – ap. № 17C

**APARTMENT № 41C**  
 pertinents:  
 - area – 51.60 m<sup>2</sup>  
 - shared parts – 11.01 m<sup>2</sup>  
 - total area – 62.61 m<sup>2</sup>  
 - terrace – 9.07 m<sup>2</sup>  
 description:  
 - 1 bedroom  
 - view – WEST  
 boundaries:  
 - east – ap. № 18C  
 - west – ap. № 20C  
 - north – corridor  
 - south – yard

**APARTMENT № 44C**  
 pertinents:  
 - area – 77.64 m<sup>2</sup>  
 - shared parts – 16.56 m<sup>2</sup>  
 - total area – 94.20 m<sup>2</sup>  
 - terrace – 11.77 m<sup>2</sup>  
 description:  
 - 1 bedroom  
 - view – WEST  
 boundaries:  
 - east – corridor  
 - west – yard  
 - north – store, staircase  
 - south – ap. № 21C

**APARTMENT № 42A**  
 pertinents:  
 - area – 53.64 m<sup>2</sup>  
 - shared parts – 11.44 m<sup>2</sup>  
 - total area – 65.08 m<sup>2</sup>  
 - terrace – 4.75 m<sup>2</sup>  
 description:  
 - studio  
 - view – POOL & SEA  
 boundaries:  
 - north & west – corridor  
 - east – corridor & yard  
 - south – ap. № 21A

**APARTMENT № 45A**  
 pertinents:  
 - area – 54.15 m<sup>2</sup>  
 - shared parts – 11.55 m<sup>2</sup>  
 - total area – 65.70 m<sup>2</sup>  
 - terrace – 6.91 m<sup>2</sup>  
 description:  
 - 1 bedroom  
 - view – POOL & SEA  
 boundaries:  
 - east – yard  
 - west – corridor  
 - north – ap. № 22A  
 - south – ap. № 11B

**APARTMENT № 48A**  
 pertinents:  
 - area – 59.39 m<sup>2</sup>  
 - shared parts – 12.67 m<sup>2</sup>  
 - total area – 72.06 m<sup>2</sup>  
 - terrace – 12.29 m<sup>2</sup>  
 description:  
 - 1 bedroom  
 - view – WEST  
 boundaries:  
 - east – corridor  
 - west – yard  
 - north – ap. № 27A  
 - south – ap. № 25A

**APARTMENT № 33B**  
 pertinents:  
 - area – 57.90 m<sup>2</sup>  
 - shared parts – 12.35 m<sup>2</sup>  
 - total area – 70.25 m<sup>2</sup>  
 - terrace – 8.50 m<sup>2</sup>  
 description:  
 - 1 bedroom  
 - view – POOL & SEA  
 boundaries:  
 - east – yard  
 - west – corridor  
 - north – ap. № 12B  
 - south – ap. № 14B

**APARTMENT № 38B**  
 pertinents:  
 - area – 60.60 m<sup>2</sup>  
 - shared parts – 12.93 m<sup>2</sup>  
 - total area – 73.53 m<sup>2</sup>  
 - terrace – 11.18 m<sup>2</sup>  
 description:  
 - 1 bedroom  
 - view – WEST  
 boundaries:  
 - east – corridor  
 - west – yard  
 - north – ap. № 19B  
 - south – ap. № 17B

**APARTMENT № 39B**  
 pertinents:  
 - area – 60.60 m<sup>2</sup>  
 - shared parts – 12.93 m<sup>2</sup>  
 - total area – 73.53 m<sup>2</sup>  
 - terrace – 11.18 m<sup>2</sup>  
 description:  
 - 1 bedroom  
 - view – WEST  
 boundaries:  
 - east – corridor  
 - west – yard  
 - north – ap. № 20B  
 - south – ap. № 18B

**APARTMENT № 36C**  
 pertinents:  
 - area – 37.19 m<sup>2</sup>  
 - shared parts – 7.93 m<sup>2</sup>  
 - total area – 45.12 m<sup>2</sup>  
 - terrace – 4.69 m<sup>2</sup>  
 description:  
 - studio  
 - view – POOL  
 boundaries:  
 - east – yard  
 - west – corridor  
 - north – ap. № 13C  
 - south – ap. № 15C

**APARTMENT № 39C**  
 pertinents:  
 - area – 69.70 m<sup>2</sup>  
 - shared parts – 14.87 m<sup>2</sup>  
 - total area – 84.57 m<sup>2</sup>  
 - terrace – 10.69 m<sup>2</sup>  
 description:  
 - 2 bedrooms  
 - view – POOL  
 boundaries:  
 - east & south – yard  
 - west – corridor  
 - north – ap. № 16C

**APARTMENT № 42C**  
 pertinents:  
 - area – 59.14 m<sup>2</sup>  
 - shared parts – 12.62 m<sup>2</sup>  
 - total area – 71.76 m<sup>2</sup>  
 - terrace – 12.29 m<sup>2</sup>  
 description:  
 - 1 bedroom  
 - view – WEST  
 boundaries:  
 - east – ap. № 19C  
 - west – ap. № 21C  
 - north – corridor  
 - south – yard

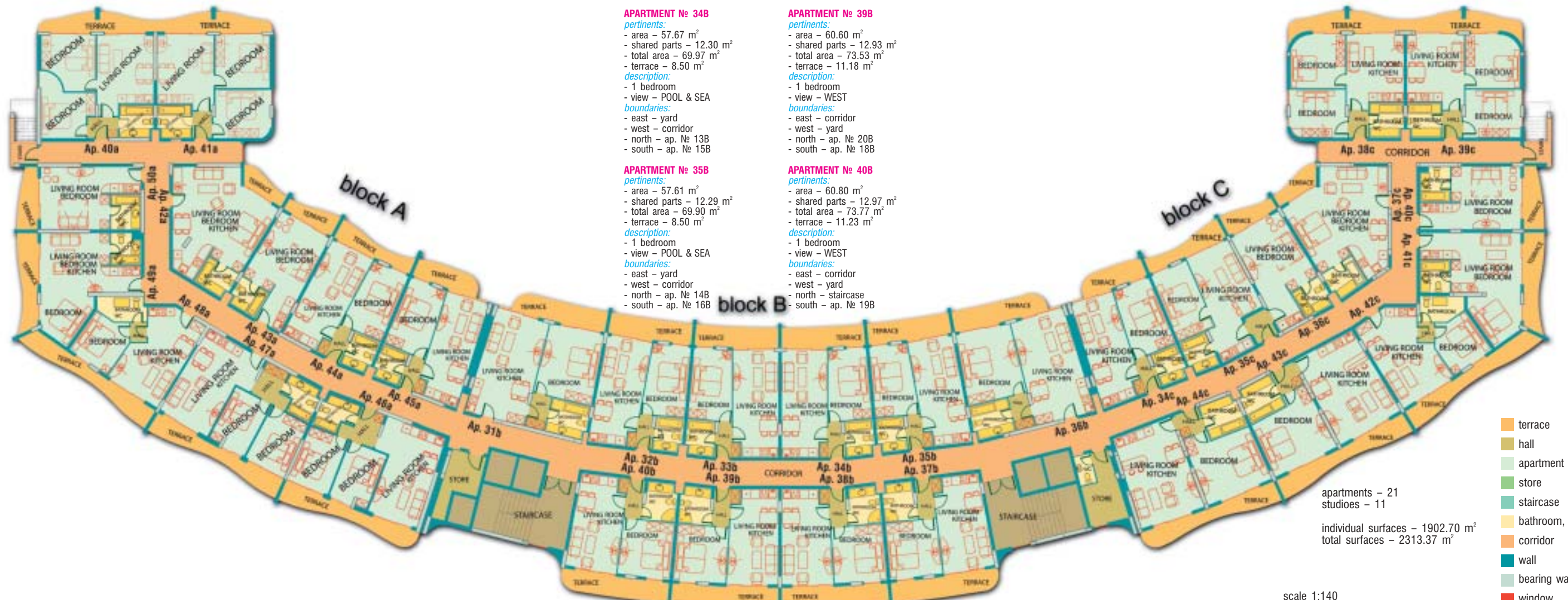

- terrace
- hall
- apartment
- store
- staircase
- bathroom, wc
- corridor
- wall
- bearing wall
- window

scale 1:140

apartments – 21  
 studios – 11  
 individual surfaces – 1902.70 m<sup>2</sup>  
 total surfaces – 2313.37 m<sup>2</sup>